

CSUCD 52

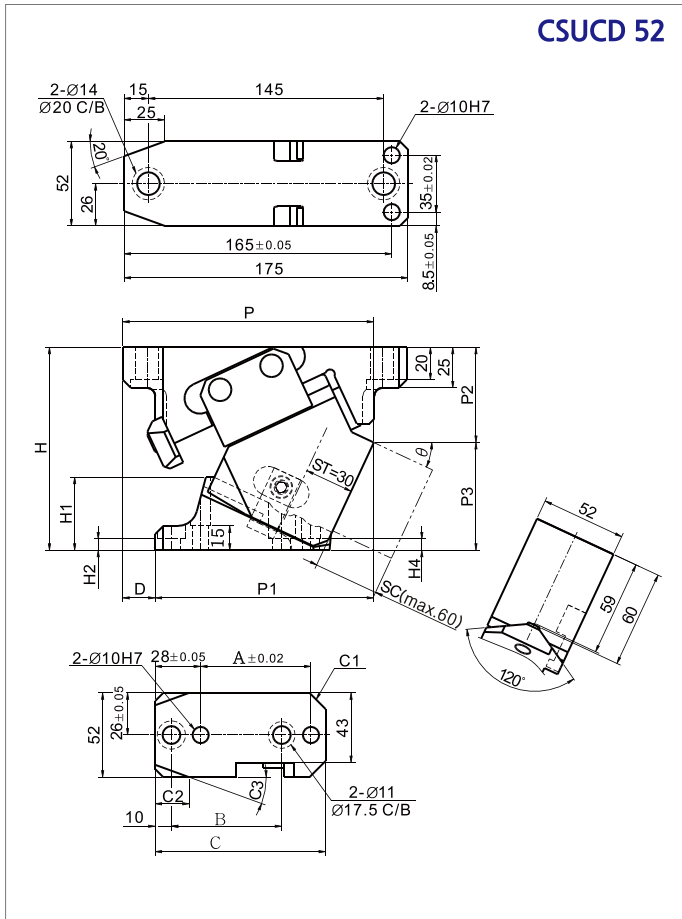

■ Working Face (Option)

SC: The mount surface is extended forward in the range of 1 to 60mm (in increments of 1mm).

Catalog No.	Working Face (W)	Stroke (ST)	θ	P	P1	P2	P3	D	H	H1	H2	H4	C1	C2	C3	C4	C5	A	B	C		
CSUCD	52	19.3	0	150.00	105.00	43.00	82.00	45		21												
		21.3	5	153.10	111.10	45.21	79.79	42		26		15										
		23.3	10	153.55	116.55	47.83	77.17	37		31			5									
		25.4	15	153.32	121.32	50.82	74.18	32		36			10									
		27.6	20	153.38	126.38	55.10	69.90	27		40				10								
		30	25	154.71	134.71	58.62	66.38	20		45												
		32.6	30	153.28	136.28	63.31	61.69	17		49												
		35.4	35	152.09	142.09	67.1	57.90	10	125	54							59	60	68	68	105	
		38.6	40	149.14	145.14	71.93	53.07	4		58												
		42.3	45	145.41	149.41	75.73	49.27	-4		63												
		46.7	50	143.92	152.92	79.43	45.57	-9		67												
		52.3	55	144.67	154.67	82.97	42.03	-10		73							20					
		60	60	150.69	159.69	90.28	34.72	-9		74												
		47.3	65	130.16	175.16	99.54	25.46	-45		73												
		58.5	70	133.62	173.62	106.97	18.03	-40		72.5												
		46.3	75																			
		57.3	80	148.74	178.74	124.59	24.41	-30	150	83												
																						111
																						110



Order CSUCD52-30
CSUCD52-50-SC30