



■ Mounting Method

N : Pin mounting

■ Working Face (Option)

Blank : Drawing Shape

B : 30 mm extension

■ Pin Hole

Blank : Drawing shape

A : Dimension & Tolerance

CHCG 50 (N)

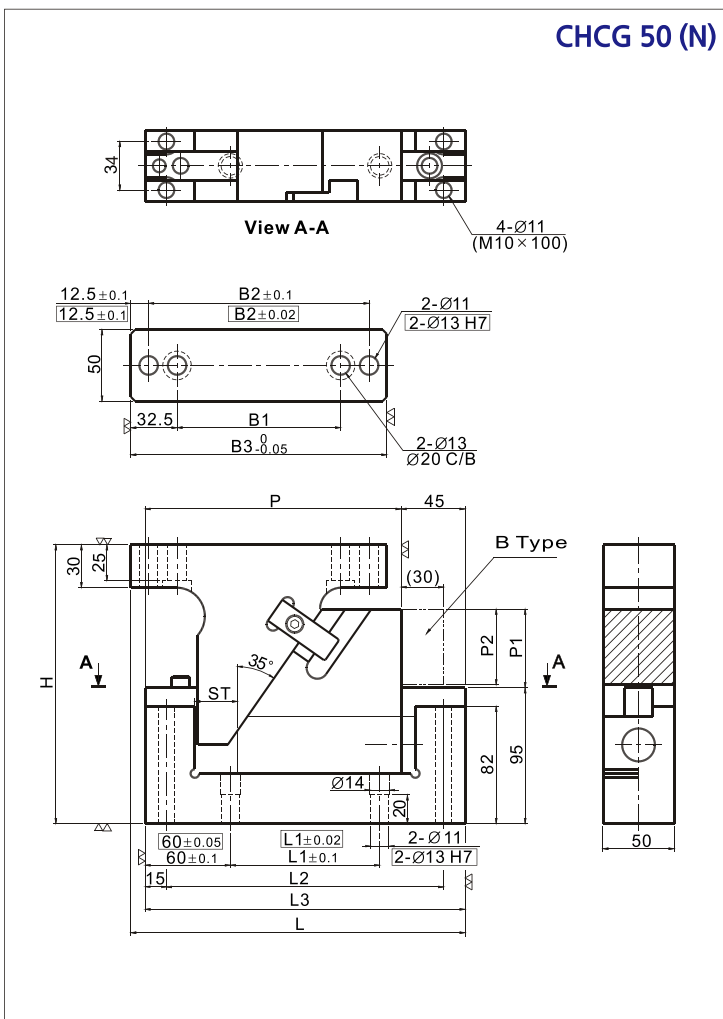

Catalog No.	Working Face Width	Stroke	P	P1	P2	L	L1	L2	L3	B1	B2	B3	H
CHCG	50	30	180	55	53	235	105	195	225	115	155	180	195
		60	210	70	68	265	135	225	255	145	185	210	210



Order CHCG50-60-N-A
CHCG50-30-B-N

CHCG 50 (K)

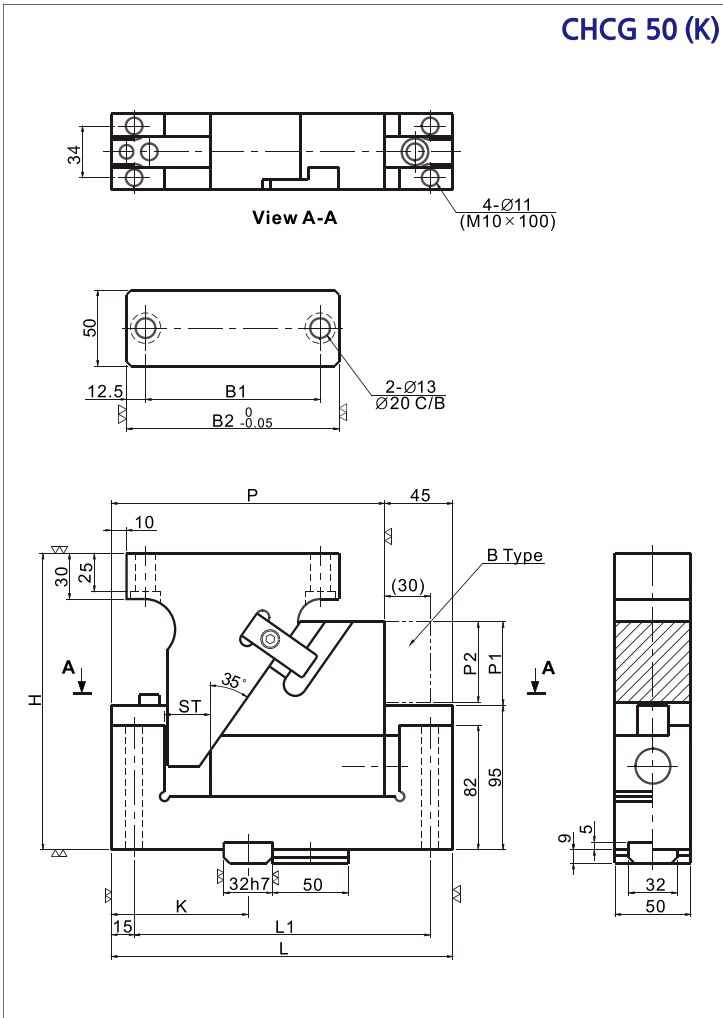

■ Mounting Method

K : Key mounting

■ Working Face (Option)

Blank : Drawing shape

B : 30 mm extension

Catalog No.	Working Face Width	Stroke	P	P1	P2	L	L1	K	B1	B2	H
CHCG	50	30	180	55	53	235	195	90	115	140	195
		60	210	70	68	265	225	120	145	170	210



Order CHCG50-60-K
CHCG50-30-B-K